

NSK-RA30 - Linear Guides

Rail Part Number	Rail Dimensions (mm)							Weight (lbs)
	W ₁	H ₁	G	F	d x D x h	B ₃	Rail Length (mm)	
NSK-R1A30L-100-10-10	28	28	20	40	9x14x12	14	100	1.1
NSK-R1A30L-300-10-10	28	28	20	40	9x14x12	14	300	3.2
NSK-R1A30L-500-10-10	28	28	20	40	9x14x12	14	500	5.4
NSK-R1A30L-700-10-10	28	28	20	40	9x14x12	14	700	7.6
NSK-R1A30L-900-10-10	28	28	20	40	9x14x12	14	900	9.7
NSK-R1A30L-1100-10-10	28	28	20	40	9x14x12	14	1100	11.9
NSK-R1A30L-1300-10-10	28	28	20	40	9x14x12	14	1300	14.0
NSK-R1A30L-1500-10-10	28	28	20	40	9x14x12	14	1500	16.2
NSK-R1A30L-1700-10-10	28	28	20	40	9x14x12	14	1700	18.4
NSK-R1A30L-1900-10-10	28	28	20	40	9x14x12	14	1900	20.5
NSK-R1A30L-2100-10-10	28	28	20	40	9x14x12	14	2100	22.7
NSK-R1A30L-2300-10-10	28	28	20	40	9x14x12	14	2300	24.8
NSK-R1A30L-2500-10-10	28	28	20	40	9x14x12	14	2500	27.0
NSK-R1A30L-2700-10-10	28	28	20	40	9x14x12	14	2700	29.2
NSK-R1A30L-2900-10-10	28	28	20	40	9x14x12	14	2900	31.3
NSK-R1A30L-3100-10-10	28	28	20	40	9x14x12	14	3100	33.5
NSK-R1A30L-3300-10-10	28	28	20	40	9x14x12	14	3300	35.6
NSK-R1A30L-3500L	28	28	20	40	9x14x12	14	3500	37.8

AN, AL Square Type

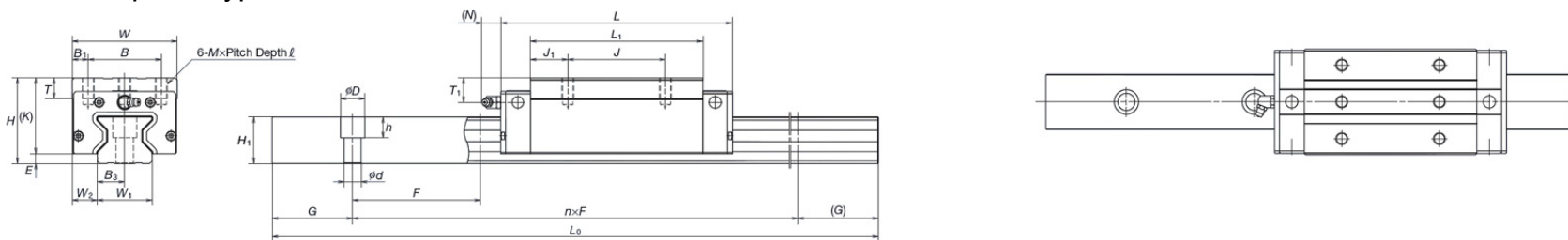

Block Part Number	Fabrication Dimension (mm)		Block Dimensions (mm)											Load Capacities (kN)		Static Moment (Nm)			Weight (lbs)	
	H	W ₂	W	L	L ₁	B	B ₁	E	J ₁	T ₁	N	J	K	T	C	C ₁	M _{r0}	M _{p0}		M _{y0}
NSK-RAA30ANP6Z	45	16	60	110.8	74	40	10	6.5	17	10	11	40	38.5	14	38.9	93.5	1670	1140	1140	2.2
NSK-RAA30ALP6Z	42	16	60	110.8	74	40	10	6.5	17	7	11	40	35.5	14	38.9	93.5	1670	1140	1140	1.87

The rated load capacities and static moment values are calculated according to the ISO Standards (ISO14728-1) for linear guides. If the above basic dynamic load rating (100km) is converted into 50km rating, use the formula:

$C_{50km} = 1.23 \times C_{100km}$. With the RA series, the dynamic load rating is the same in both the vertical and horizontal directions (4-way load specifications).

Distributed by Anaheim Automation, Inc.
 USA Stock in Anaheim, CA
 1-800-345-9401
www.anaheimautomation.com

BN, BL, Low-Profile Type

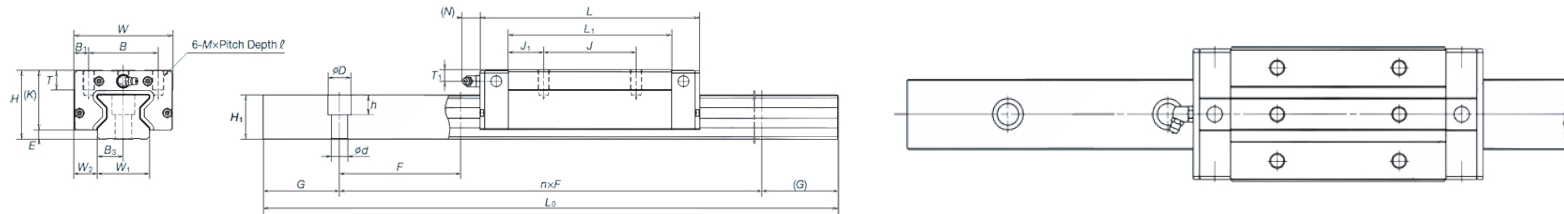

Block Part Number	Fabrication Dimension (mm)		Block Dimensions (mm)												Load Capacities (kN)		Static Moment (Nm)			Weight (lbs)
	H	W ₂	W	L	L ₁	B	B ₁	E	J ₁	T ₁	N	J	K	T	C	C ₀	M _{r0}	M _{p0}	M _{y0}	
NSK-RAA30BNP6Z	45	16	60	135.4	98.6	40	10	6.5	19.3	10	11	60	38.5	14	47.6	121	2170	1950	1950	2.2
NSK-RAA30BLP6Z	42	16	60	135.4	98.6	40	10	6.5	19.3	7	11	60	35.5	14	47.6	121	2170	1950	1950	2.43

EM, GM Flange Type

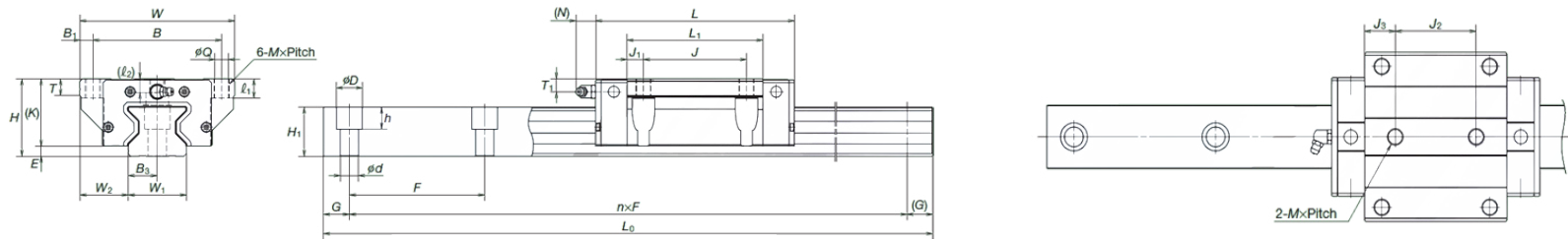

Block Part Number	Fabrication Dimension (mm)		Block Dimensions (mm)												Load Capacities (kN)		Static Moment (Nm)			Weight (lbs)
	H	W ₂	W	L	L ₁	B	B ₁	E	J ₁	T ₁	N	J	K	T	C	C ₀	M _{r0}	M _{p0}	M _{y0}	
NSK-RAA30EMP6Z	42	31	90	110.8	74	72	9	6.5	11	7	11	52	35.5	11	38.9	93.5	1670	1140	1140	2.87
NSK-RAA30GMP6Z	42	31	90	135.4	98.6	72	9	6.5	23.3	7	11	52	35.5	11	47.6	121	2170	1950	1950	3.74